

Drama, Film and Theatre Studies

Activity Cards



Oide



Matching Activity

Description:

This activity helps participants to understand stage types and develop language and understanding around stages.

Method:

- In groups, participants receive three sets of cards: (1) Stage images, (2) Stage names and (3) Descriptions associated with different stage types.
- Each group aims to match one image of a stage with the relevant stage name and description.



Oide



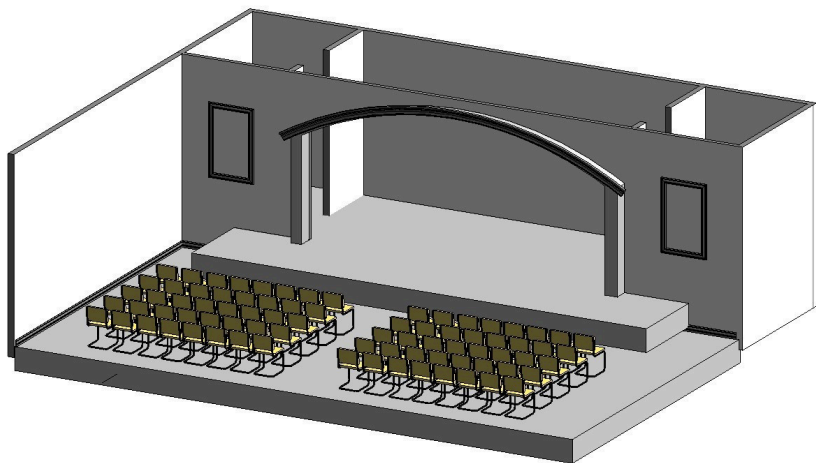

Oide



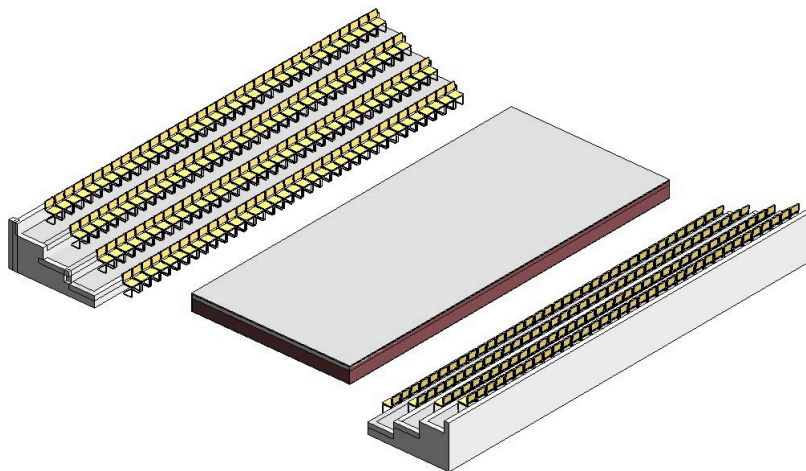

Oide



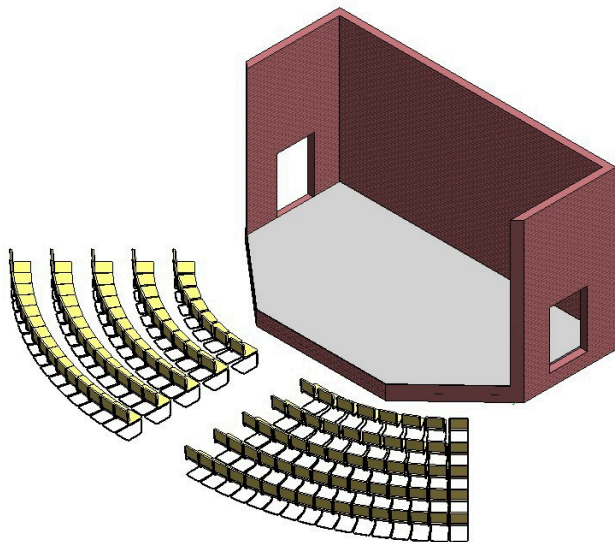

Oide



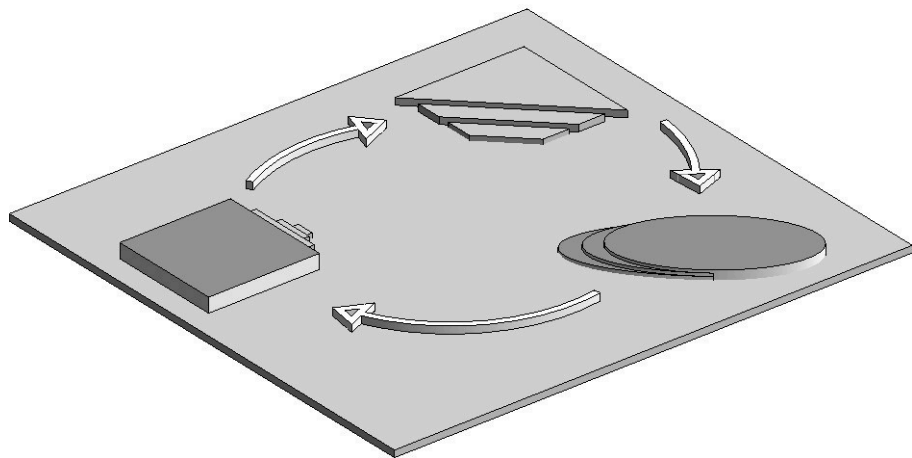

Oide



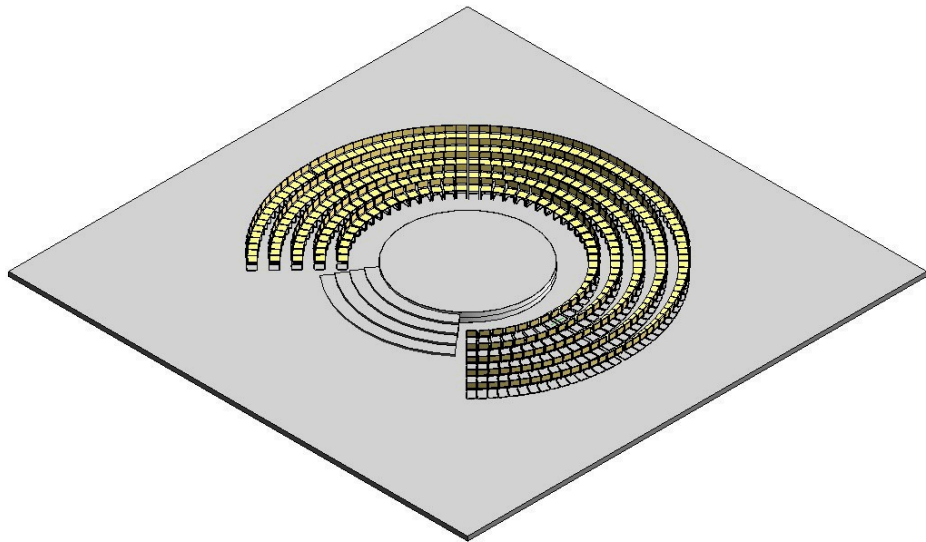

Oide



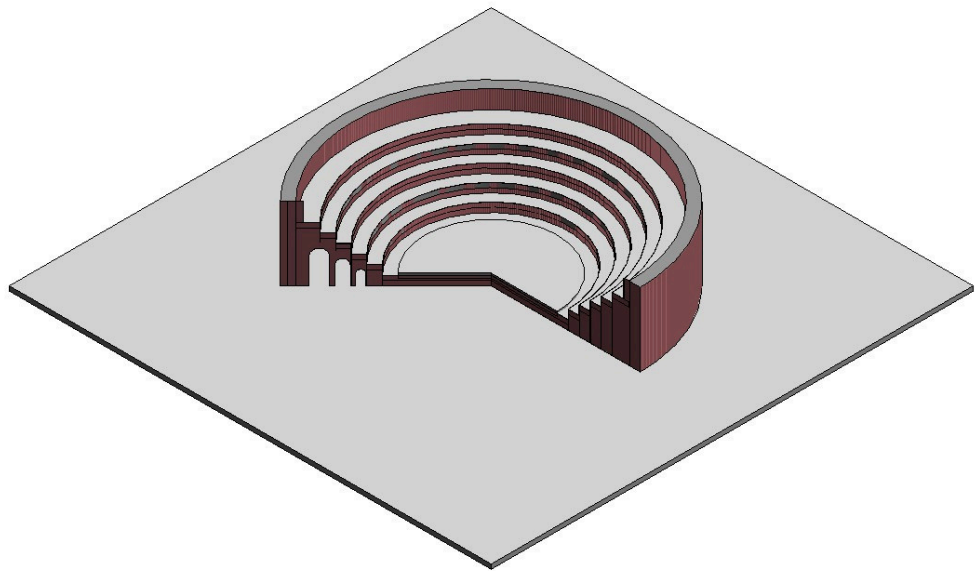

Oide



Proscenium Arch



Oide



In the Round



Oide



Thrust



Oide



Promenade



Oide



Amphitheatre



Oide



Realism

Naturalism

Traditional Drama

Apron

Frame



Oide



Contemporary Drama
Physical Theatre
Minimalist
Immersive experience
Central Staging



Oide



Shakespearean Drama

Elizabethan Period

Verse Drama

Immersive

Protruding



Oide



Physical Theatre
Site-Specific Theatre
Interactive
Immersive
Active spectator



Oide



Classical Tragedy
Epic Theatre
Ancient Greek
Roman
Chorus-led drama



Oide



Creating Characters

Description:

This activity helps participants to develop characters.

Method:

- Each participant chooses one Physical Attribute card and one Appearance Attribute card.
- Without speaking, each participant must embody both attributes using movement and expression. Costumes or props should not be used.
- Participants walk around the space in character.
- Other participants must try to guess the attributes.

Possible extension:

Participants might add dialogue, swap cards, or improvise scenes between characters when they meet.



Physical Attribute

Walks with a limp



Oide



Physical Attribute

Constantly clicks
their fingers



Oide



Physical Attribute

Always scratching
their head



Oide



Physical Attribute

Keeps adjusting
their clothes



Oide



Physical Attribute

Runs everywhere
instead of walking



Oide



Physical Attribute

Can't stop yawning



Oide



Physical Attribute

Trembles or shakes
slightly



Oide



Physical Attribute

Rubs their hands
together often



Oide



Physical Attribute

Moves in slow motion



Oide



Physical Attribute

Keeps stretching
their neck



Oide



Physical Attribute

Taps their foot
impatiently



Oide



Physical Attribute

Always looking over
their shoulder



Oide



Physical Attribute

Has exaggerated posture
(very tall or hunched)



Oide



Physical Attribute

Sneezes repeatedly



Oide



Physical Attribute

Constantly checking
a watch



Oide



Physical Attribute

Crosses arms
defensively



Oide



Physical Attribute

Fidgets with
their fingers



Oide



Physical Attribute

Always balancing
on one foot



Oide



Physical Attribute

Holds one arm stiffly



Oide



Physical Attribute

Takes tiny, tiptoe steps



Oide



Physical Attribute

Has a booming laugh



Oide



Physical Attribute

Overly dramatic
gestures



Oide



Physical Attribute

Keeps dropping things



Oide



Physical Attribute

Bites fingernails
nervously



Oide



Physical Attribute

Sniffs loudly
every few seconds



Oide



Physical Attribute

Tilts head
when listening



Oide



Physical Attribute

Jumps at small sounds



Oide



Physical Attribute

Always clapping hands



Oide



Physical Attribute

Cannot sit still



Oide



Physical Attribute

Leans very close
when talking



Oide



Physical Attribute

Constantly rubbing
their eyes



Oide



Physical Attribute

Keeps losing
balance slightly



Oide



Physical Attribute

Keeps peering into
the distance



Oide



Physical Attribute

Always folding
and unfolding arms



Oide



Physical Attribute

Moves as if in a
strong wind



Oide



Physical Attribute

Keeps checking
their pockets



Oide



Physical Attribute

Looks around as if
afraid of being followed



Oide



Physical Attribute

Twitches an eye
or cheek occasionally



Oide



Physical Attribute

Constantly dusting
themselves off



Oide



Appearance Attribute

Delighted with their
perfectly neat hair



Oide



Appearance Attribute

Has a wild, untidy
hairstyle



Oide



Appearance Attribute

Always fixing/flicking
their hair



Oide



Proud of their
appearance



Embarrassed about
how they look



Appearance Attribute

Struts as if they are
on a fashion runway



Oide



Appearance Attribute

Constantly checking
their reflection



Oide



Appearance Attribute

Looks like they
have just woken up



Oide



Appearance Attribute

Tries to hide their face



Oide



Appearance Attribute

Walks as if wearing
very high heels



Oide



Appearance Attribute

Moves as if their
clothes are too tight



Oide



Appearance Attribute

Walks proudly as if
wearing a uniform



Oide



Appearance Attribute

Very proud of their
beard/moustache



Oide



Appearance Attribute

Behaves as if their
outfit is very expensive



Oide



Appearance Attribute

Moves awkwardly
as if clothes don't fit



Oide



Appearance Attribute

Acts as if they are
wearing a disguise



Oide



Appearance Attribute

Keeps adjusting an
imaginary accessory
(hat, tie, glasses, etc.)



Oide



Appearance Attribute

Shows off as if
covered in jewellery



Oide



Appearance Attribute

Carries themselves as
if covered in mud or dirt



Oide



Appearance Attribute

Acts as if they
smell bad



Oide



Appearance Attribute

Behaves as if they look
amazing and know it



Oide



Appearance Attribute

Seems shy or
self-conscious about
their looks

Appearance Attribute

Moves as if trying to
stay clean and perfect



Oide



Acts as if wearing
camouflage



Appearance Attribute

Thinks they are wearing
an invisibility cloak



Oide



Appearance Attribute

Acts as if they're trying
to impress someone



Oide



Appearance Attribute

Carries themselves
like a celebrity



Oide



Appearance Attribute

Moves as if wearing
heavy boots



Oide



Appearance Attribute

Acts as if wearing
something too
hot or itchy



Oide



Appearance Attribute

Walks as if they are
carrying something
they love



Oide



Appearance Attribute

Behaves as if they
are freezing cold



Oide



Appearance Attribute

Thinks they are in
a superhero costume



Oide



Appearance Attribute

Moves as if they are
soaked from rain



Oide



Appearance Attribute

Moves as if wearing a
flowing cape or long
dress



Oide



Appearance Attribute

Moves as if they have a
thorn in their foot



Oide



Emotional State

Overjoyed
and cannot hide it



Oide



Emotional State

Constantly anxious
about something



Oide



Emotional State

Secretly furious but
trying to stay calm



Oide



Emotional State

Sad but pretending
to be fine



Oide



Emotional State

Bored
and disinterested



Oide



Emotional State

Nervously excited
about something



Oide



Emotional State

Easily startled
by everything



Oide



Emotional State

Embarrassed and
trying to hide it



Oide



Emotional State

Overly confident
and proud



Oide



Emotional State

Quietly hopeful



Oide



Emotional State

Suspicious
of everyone



Oide



Emotional State

Easily distracted
and forgetful



Oide



Emotional State

Deeply in love



Oide



Emotional State

Jealous of others



Oide



Emotional State

Daydreaming
constantly



Oide



Emotional State

Irritated by everything

Emotional State

Giggly and childish



Oide



Emotional State

Desperate to impress

Emotional State

Full of curiosity
about everyone



Oide



Emotional State

Overly dramatic
about small things



Oide



Emotional State

Restless and impatient



Oide



Emotional State

Peaceful and dreamy

Setting the Scene: Verbatim Theatre

Description

This activity explores how real voices and lived experiences are transformed into performances.

Method

- In pairs, participants interview each other on a clear and simple prompt chosen from a selection of prompt cards.
- The first participant responds to the prompt, speaking for about a minute.
- The second participant listens closely and takes notes on the story.
- The second participant chooses a few striking phrases or sentences their partner said word for word (no editing — keep the “ums”, pauses etc).
- The second participant now speaks back a selection of their partner’s words by speaking them verbatim.
- The second participant performs, choosing intonation, pause, rhythm, gesture etc.
- Participants swap roles and repeat the process with a different prompt in use.



Verbatim Theatre Prompt

Tell me about your
favourite film.



Oide



Verbatim Theatre Prompt

Tell me about your
favourite theatre
experience.



Oide



Verbatim Theatre Prompt

What is the best
advice you were ever
given?

Verbatim Theatre Prompt

Tell me about a
memorable holiday.



Oide



Verbatim Theatre Prompt

Tell me about the
most inspiring book
you ever read.



Oide



Setting the Scene: Non-naturalism

Description

This activity explores how non-naturalistic theatre uses stylisation, exaggeration, symbolism, and transformation rather than realism.

Method

- In pairs or trios, participants choose a scenario card.
- Improvise a short (30 - 60 seconds), natural, everyday scene based on the card.
- Participants select a non-naturalistic prompt card.
- Participants improvise the scene again applying the non-naturalistic style.
- Each group performs both versions.
- Remaining participants watch performances.



Non-naturalism Scenario

Waiting for a bus



Oide



Non-naturalism Scenario

Ordering a coffee



Oide



Non-naturalism Scenario

Getting ready for school



Oide



Non-naturalism Scenario

Meeting your
neighbour outside
your house



Oide



Non-naturalism Scenario

At the checkout in the supermarket

Non-naturalism Prompt

Make every movement
10 times bigger



Oide



Non-naturalism Prompt

Perform in
slow-motion



Oide



Non-naturalism Prompt

Perform 10 times
quicker



Oide



Non-naturalism Prompt

All characters speak in
chorus OR echo



Oide



Non-naturalism Prompt

Add a prop: characters
hold the prop like a
‘hot-potato’



Oide



Spotlight on Stages

Description

This activity explores the different types of stages and how the type of stage has an impact on the creative decisions.

Method

- In groups, present your chosen stage layout to whole group.
- Each group gets one stage card.
- Use string or card to map out the shape of your chosen stage on the floor.
- Each person chooses a theatre role and explains how this type of stage has an impact on this role.
- Present your stage to the whole group and explain the impact it has on the roles.



Theatre Role

Actor(s)



Oide



Set Design



Audience



Lighting



Director



Proscenium Arch

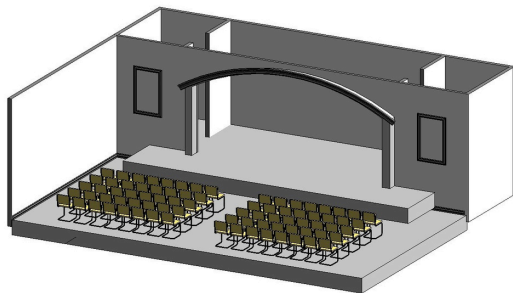

In the Round

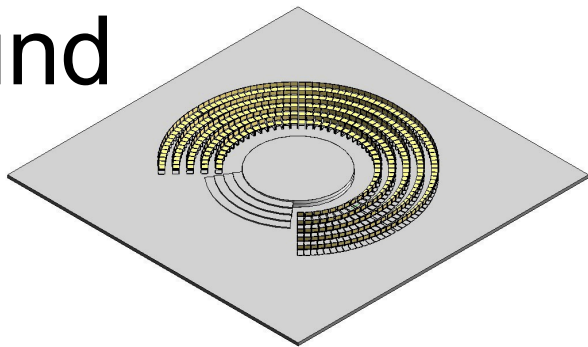

Spotlight on Stages

Thrust

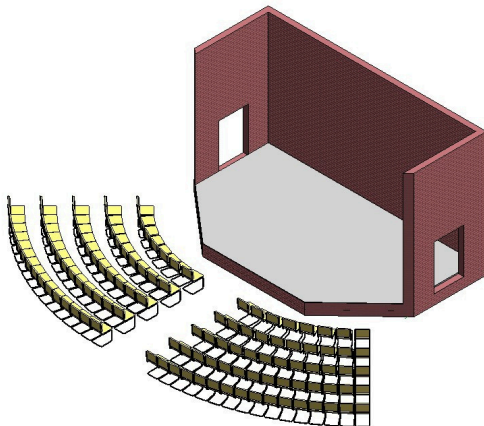

Oide



Promenade

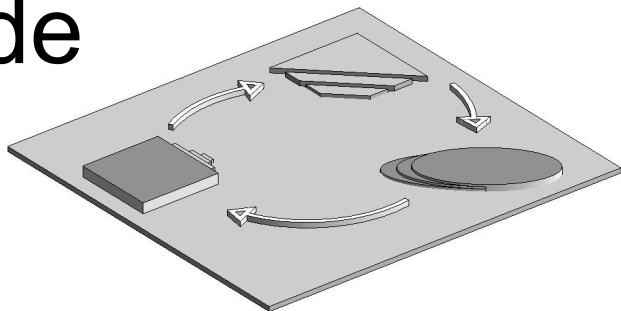

Amphitheatre

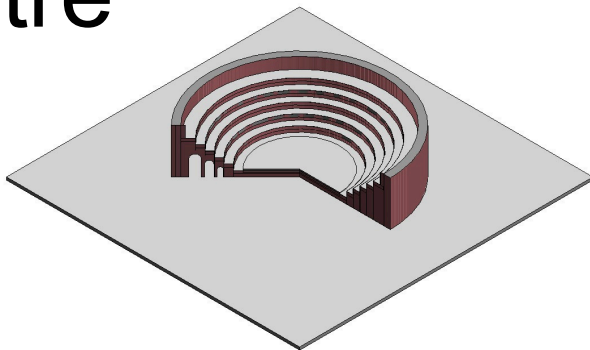

Traverse

